

# OG / W SEAT 'IMPERIAL - CENTRAL O-RING MOUNTED' SPECIFICATION SHEET

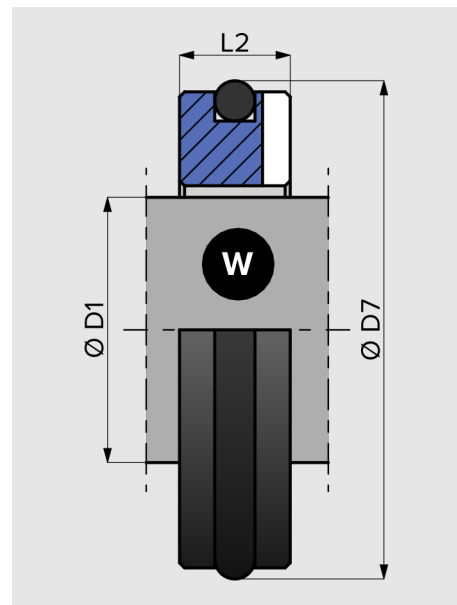
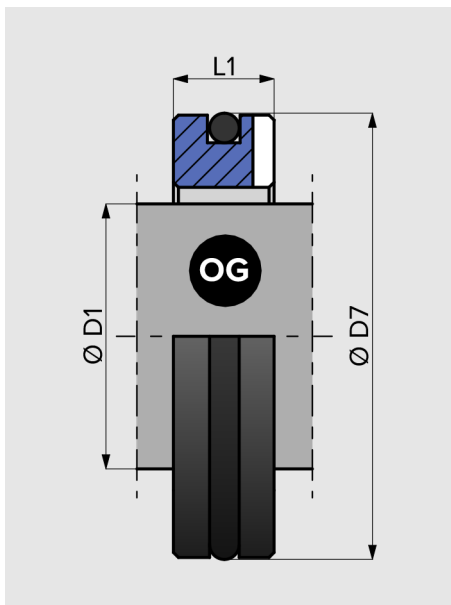
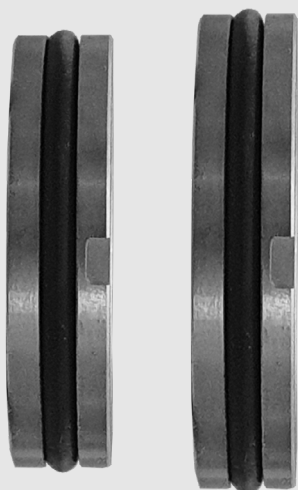

- ▶ Central O-ring mounted
- ▶ Improved heat transfer
- ▶ Anti-rotation by pin

O-ring mounted stationaries cover a wide range of application requirements for general services. The elastomer O-ring is contained in a recess within the seat section, rather than in the housing. As the seat comes in direct contact with the base of the housing recess, it has better heat transfer / dissipation compared to boot mounted stationaries.

An anti-rotation pin can be used for specialised duties and high viscosity fluids.

'OG' is an old code, with OD or cavity size to suit American (US) standards.

W is John Crane's code for cavity sizes to suit European (UK) standards.

▶ **Materials of Construction**

Stationary Face: SiC or TC  
Elastomer: N, V or EP

**OG EQUIVALENT (US)**

AES: S07U  
Vulcan: Type 31

**W EQUIVALENT (EURO)**

AES: S070U  
Vulc.: Type 21

## OG SEAT

US - Standard

D1	D7	L1	
0.375"	0.875"	22.23	8.0
0.500"	1.000"	25.40	8.0
0.625"	1.250"	31.75	10.3
0.750"	1.375"	34.93	10.3
0.875"	1.500"	38.10	10.3
1.000"	1.625"	41.28	11.0
1.125"	1.750"	44.45	11.0
1.250"	1.875"	47.63	11.0
1.375"	2.000"	50.80	11.0
1.500"	2.125"	53.98	11.0
1.625"	2.375"	60.33	12.7
1.750"	2.500"	63.50	12.7
1.875"	2.625"	66.68	12.7
2.000"	2.750"	69.85	12.7
2.125"	3.000"	76.20	14.3
2.250"	3.125"	79.38	14.3
2.375"	3.250"	82.55	14.3
2.500"	3.375"	85.73	14.3
2.625"	3.375"	85.73	16.0
2.750"	3.500"	88.90	16.0
2.875"	3.750"	95.25	16.0
3.000"	3.875"	98.43	16.0
3.125"	4.000"	101.60	19.8
3.250"	4.125"	104.78	19.8
3.375"	4.250"	107.95	19.8
3.500"	4.375"	111.13	19.8
3.625"	4.500"	114.30	19.8
3.750"	4.625"	117.48	19.8
3.875"	4.750"	120.65	19.8
4.000"	4.875"	123.83	19.8

## W SEAT

Euro - Standard

D1	D7	L2	
0.375"	24.60	8.7	
0.500"	27.80	8.7	
0.625"	30.95	10.3	
0.750"	34.15	10.3	
0.875"	37.30	10.3	
1.000"	40.50	10.3	
1.125"	47.65	11.9	
1.250"	50.80	11.9	
1.375"	54.00	11.9	
1.500"	57.15	11.9	
1.625"	60.35	11.9	
1.750"	63.50	11.9	
1.875"	66.70	11.9	
2.000"	69.85	13.5	
2.125"	73.05	13.5	
2.250"	76.20	13.5	
2.375"	79.40	13.5	
2.500"	82.55	13.5	
2.625"	92.10	15.9	
2.750"	95.25	15.9	
2.875"	98.45	15.9	
3.000"	101.60	15.9	
3.125"	111.15	19.8	
3.250"	114.30	19.8	
3.375"	117.50	19.8	
3.500"	120.65	19.8	
3.625"	123.85	19.8	
3.750"	127.00	19.8	
3.875"	130.20	19.8	
4.000"	133.35	19.8	