

METRIC EURO SEAT

'METRIC SEATS TO EUROPEAN DIMENSIONS'
SPECIFICATION SHEET

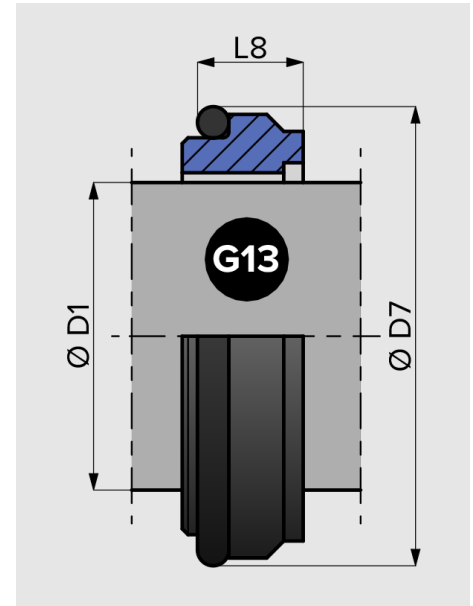
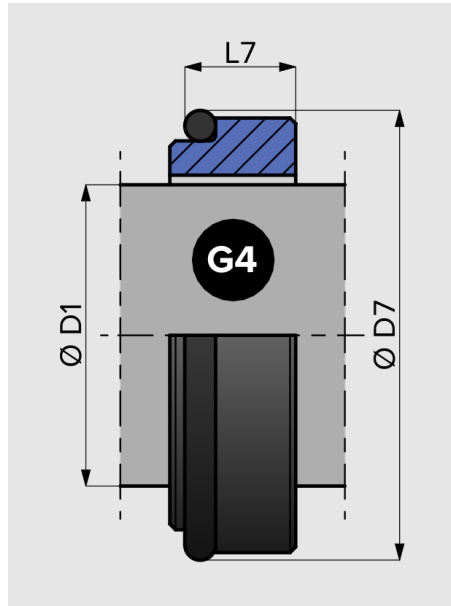
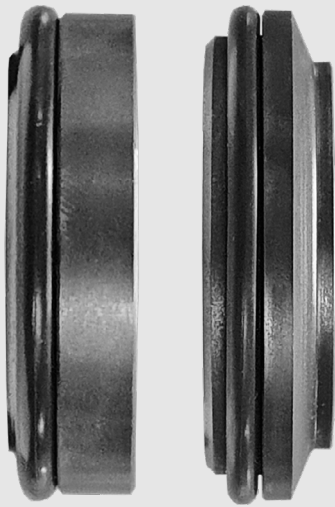

- **Metric sized shafts**
- **Suits European metric cavities**

Metric seats to suit common European metric cavities, although some sizes match up DIN cavity dimensions.

G4 seat is a non-pinned O-ring mounted stationary.

G13 seat is typically carbon face, needing to be machined to suit the rotary tracking face.

- **Materials of Construction**

Stationary Face: SiC
Elastomer: N, V or EP

G4 EQUIVALENT

Vulcan: Type 8.STD

G13 EQUIVALENT

Vulcan: 8B

D1	D7	L7
10mm	19.2	6.6
12mm	21.6	5.6
14mm	24.6	5.6
15mm	24.6	6.6
16mm	28.0	7.5
18mm	30.0	8.0
20mm	35.0	7.5
22mm	35.0	7.5
24mm	38.0	7.5
25mm	38.0	7.5
28mm	42.0	9.0
30mm	45.0	10.5
32mm	48.0	10.5
33mm	50.0	11.0
35mm	52.0	11.0
38mm	55.0	10.3
40mm	58.0	10.8
43mm	62.0	12.0
45mm	64.0	11.6
48mm	68.4	11.6
50mm	69.3	11.6
53mm	72.3	12.3
55mm	75.4	13.3
58mm	78.4	13.3
60mm	80.4	13.3
65mm	85.4	13.0
68mm	91.5	13.7
70mm	92.0	13.0
75mm	99.0	14.0
80mm	104.0	15.0
85mm	109.0	14.8
90mm	114.0	14.8
95mm	120.3	15.8
100mm	123.3	15.8

D1	D7	L8
10mm	19.2	7.1
12mm	21.6	7.6
14mm	24.6	7.6
15mm	24.6	8.6
16mm	28.0	9.0
18mm	30.0	10.0
20mm	35.0	9.5
22mm	35.0	9.5
24mm	38.0	9.5
25mm	38.0	9.5
28mm	42.0	11.0
30mm	45.0	11.0
32mm	48.0	11.0
33mm	50.0	11.5
35mm	52.0	11.5
38mm	55.0	11.5
40mm	58.0	11.5
43mm	62.0	14.3
45mm	64.0	14.3
48mm	68.4	14.3
50mm	69.3	14.3
53mm	72.3	14.3
55mm	75.4	15.3
58mm	78.4	15.3
60mm	80.4	15.3
65mm	85.4	15.3
68mm	91.5	16.0
70mm	92.0	15.3
75mm	99.0	15.3
80mm	104.0	16.3
85mm	109.0	16.3
90mm	114.0	16.3
95mm	120.3	17.3
100mm	123.3	17.3