

H80-CM

'MIXER / AGITATOR SEAL' SPECIFICATION SHEET

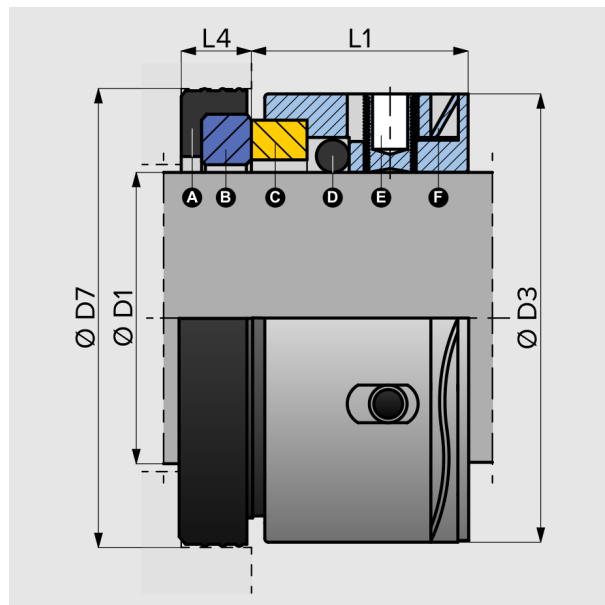
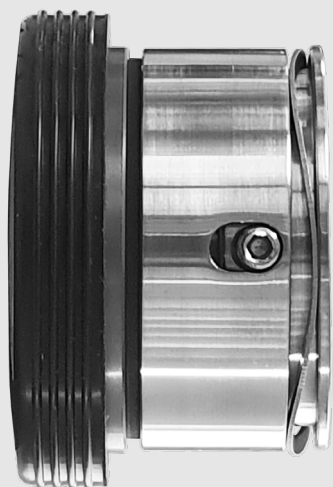

- ▶ **Mixer / Agitator seals**
- ▶ **To suit external mounting**
- ▶ **Wave-spring pusher**
- ▶ **Cup-mounted stationary**
- ▶ **Imperial shaft sizes & cavities**

H80-CM is designed to provide a compact, externally mounted mechanical seal solution for mixers and agitators. Typically suited for imperial shafts with standard stationary bore-hole sizes which are widely available

As cup mounted stationaries are typically only available in carbide (SiC, TC or CER) materials, the rotary face is inserted face to ensure alignment of the tracking faces.

- ▶ **Operating conditions**
 Temperature: -30°C to +260°C
 Pressure: up to 17 bar, 245 psi
 Speed: up to 20m/s, 4000 fpm
- ▶ **Material options**
 Rotary Face: (CAB) inserted
 (SiC) inserted
 Stationary: SiC or CER
 Elastomer: N, V or EP
 Metal Parts: Stainless Steel

PARTS

- A** Stationary Cup
- B** Stationary Face
- C** Rotary Inserted Face
- D** O-ring
- E** Set Screw
- F** Wave-spring

DIMENSIONS

D1	D3	L1	D7		L4	
1.000"	35.2	21.1	CM	1.625"	41.28	11.0
			N	-	40.50	10.3
1.250"	42.5	21.1	CM	1.875"	47.63	11.0
			N	2.000"	50.80	12.7
1.375"	45.6	21.1	CM	2.000"	50.80	11.0
			N	-	54.00	11.9